

## SLS16A Brushless Motor Series

### General Features

- 16 mm round Frame Sizes
- Torques up to 7.00 Oz-in Peak, 2.30 Oz-in continuous
- Speeds upto 47000 RPM
- Voltage rating up to 32 Vdc
- Class B rated construction
- RoHS and CE compliant
- Slotless Brushless Design

### Available Options

- Encoder - IMS EQM35 Series
- Connectors and Matting cables
- Custom Shaft ends
- Custom Winding (Voltage or Current)
- Gearbox - IMS EL22 Series



### Technical and Performance Data

Model Number		SLS16A100	
<b>General</b>			
Maximum Terminal Voltage	Vdc		32.00
Continuous Stall Torque	Oz-in		2.38
	Nm		0.02
Continuous Current (3)	Amps		3.02
Peak Stall Torque	Oz-in		7.13
	Nm		0.0504
Peak Current (3)	Amps		8.87
18 Vdc Bus Rating	Rated Speed	RPM	12700
	Rated Torque @ Rated Speed	Oz-in	2.30
		Nm	0.0162
	Rated Output Power @ Rated Speed	Watts	22
Maximum Speed (1)	RPM		26500
24 Vdc Bus Rating	Rated Speed	RPM	21400
	Rated Torque @ Rated Speed	Oz-in	2.30
		Nm	0.0162
	Rated Output Power @ Rated Speed	Watts	36
Maximum Speed (1)	RPM		35300
32 Vdc Bus Rating	Rated Speed	RPM	34000
	Rated Torque @ Rated Speed	Oz-in	2.30
		Nm	0.0162
	Rated Output Power @ Rated Speed	Watts	58
Maximum Speed (1)	RPM		47200
Thermal Resistance	° C/W		4.0
<b>Electrical</b>			
Torque Constant (± 10%), (2)	Oz-in/Amp		0.91
	Nm/Amp		0.0064
Voltage Constant (± 10%), (2)	V/KRPM		0.67
	V s/rad		0.0064
Resistance (± 15%), (2)	Ohms		2.60
Inductance (± 15%), (2)	mH		0.02
<b>Mechanical</b>			
Inertia	Oz-In-Sec <sup>2</sup>		0.000023
	kg m <sup>2</sup>		1.60E-07
Weight	Oz		1.3
	gm		37.00
Length (L)	Inch		1.65
	mm		42.00

(1) Maximum Speed can be limited by bus voltage and feedback types

(2) Measure values at 20 °C

(3) Current values are at maximum allowable winding temperature 125 °C

## Outline Drawing and Dimensional Data

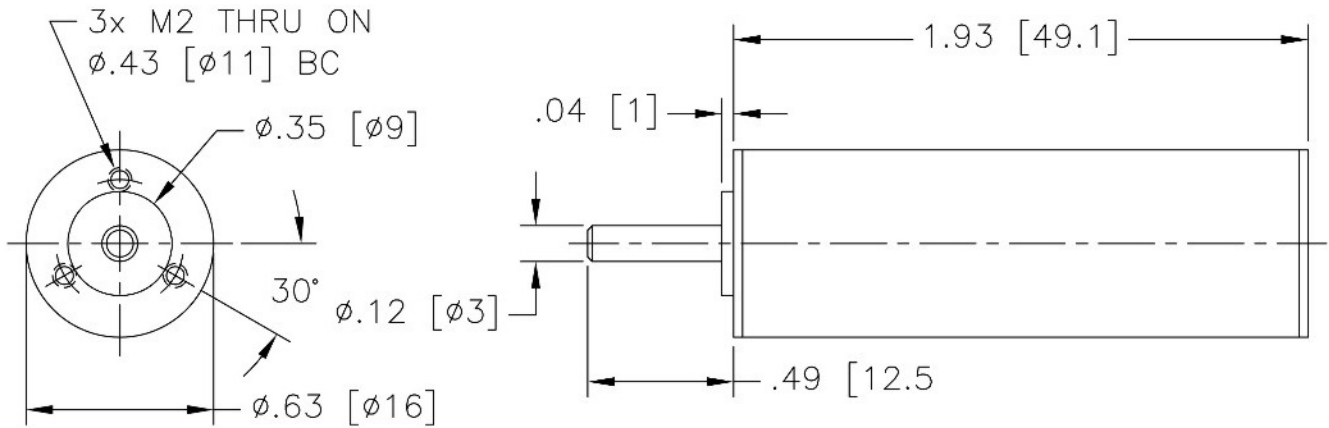

## Performance Curves

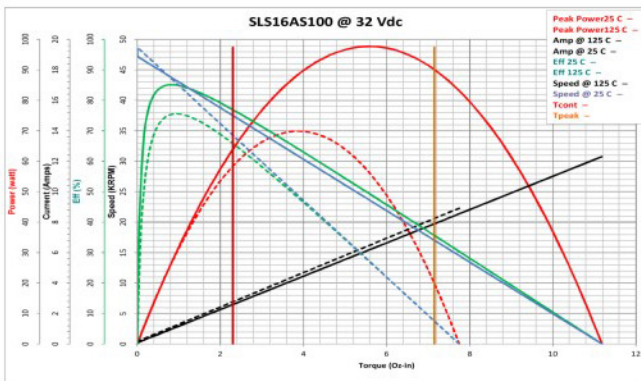
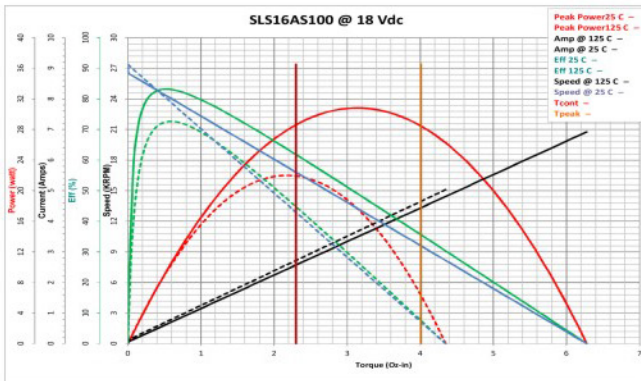

\* Motor performance curves may vary with the drive technology used

\*\* Motor performance curves may vary based upon the quality of the input voltage